

Rear Stacking Kits

(For Stacking Dryers on Washers) Part# RSK 3080

(Enclosed: 2 Brackets)

Installation Instructions

1

Using a Philips Screwdriver remove the two screws that hold the top panel of the **Washer** in place. The screws are located at the rear of the machine.

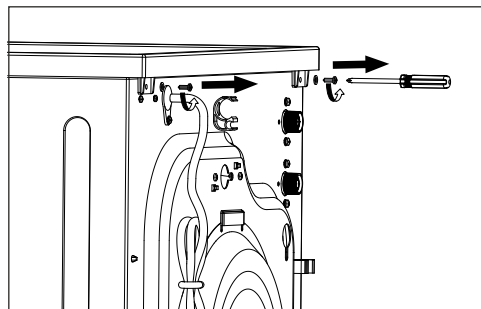

2

Stack the **Dryer** on the washer. Pull the **Dryer** out towards the back so the two rear feet are hanging out.

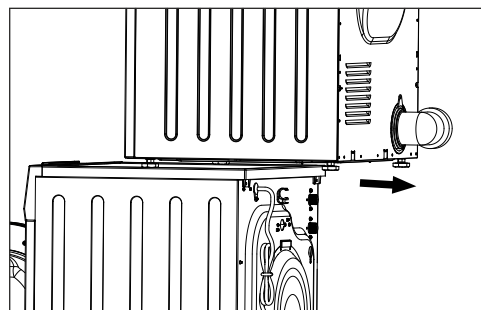

3

Unscrew the rear feet from the **Dryer**.

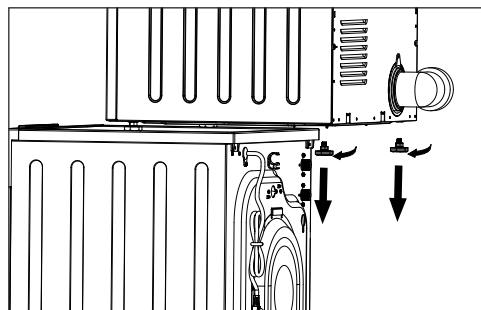

4

Align hole on the top of the bracket(s) with the holes for the feet of the **Dryer**. (Separate left and right brackets)

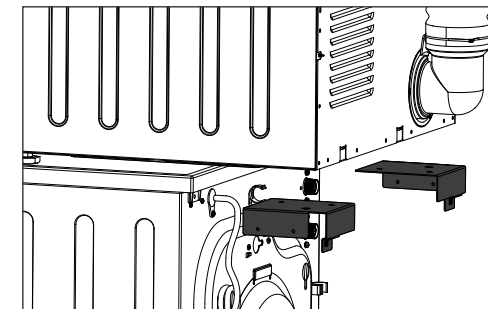

5

Screw the rear feet back into the **Dryer** with the brackets between the feet and the **Dryer**.

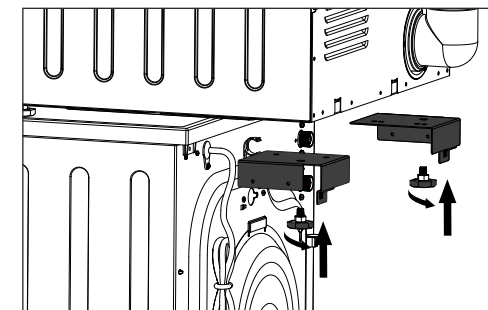

6

- Push the **Dryer** forward and align the holes at the rear of the bracket with **Washer** top panel.
- Insert the 2 screws from **Washer** top panel that were removed in Point no. 1.
- If the holes do not align properly you may need to adjust the **Dryer** feet.

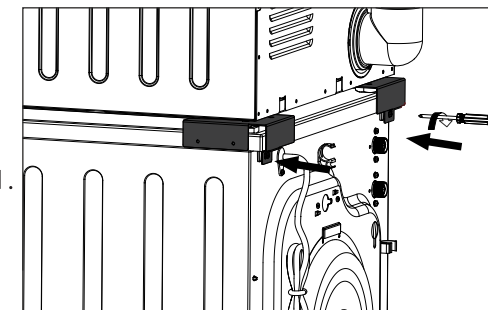

7 4 7 0 3 7 1 0 3 0 8 2

TOOLS NEEDED

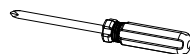

Philips screwdriver



WARNING

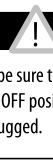

Before working on any appliance, be sure that the power ON/OFF button is in the OFF position and that the electrical cord is unplugged.

Appliance Desk Inc

10222 Georgibelle Dr, Suite 200, Houston, Texas 77043-5249

Tel: 800-490-8018 • Web: www.ApplianceDesk.com

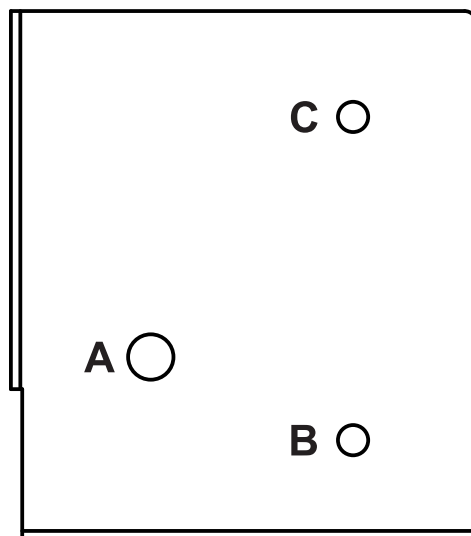

LEFT

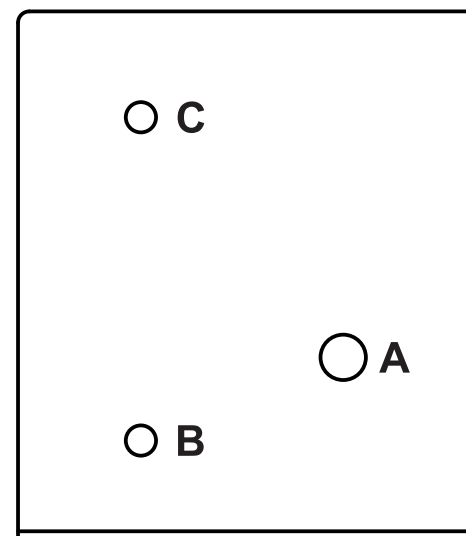

RIGHT

Hole Position	Washer	Dryer
A	835	880/870
B	835	850/852/860
C	824N/826/828	848/850/852/860/866/868